

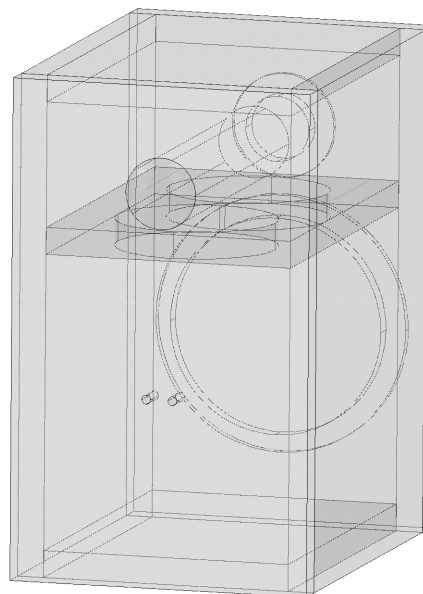

CREATIVE SOUND SOLUTIONS

CRITON 1TD
CSS LD22 + LDW7

07 - JANUARY - 2021

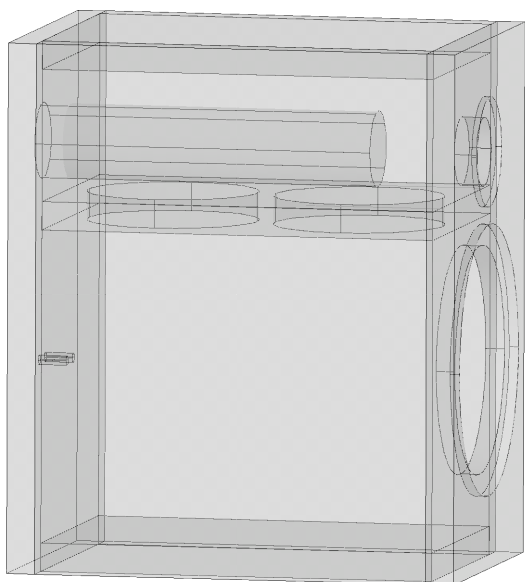
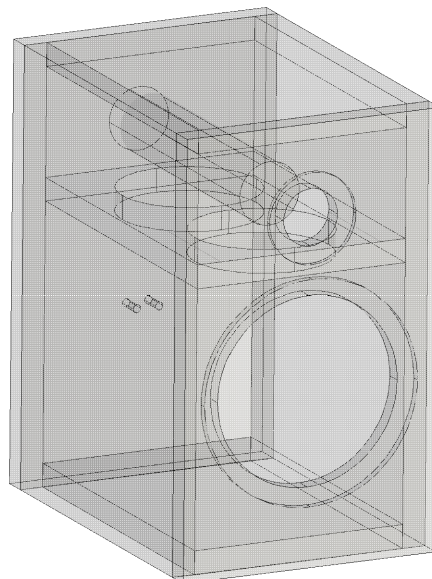
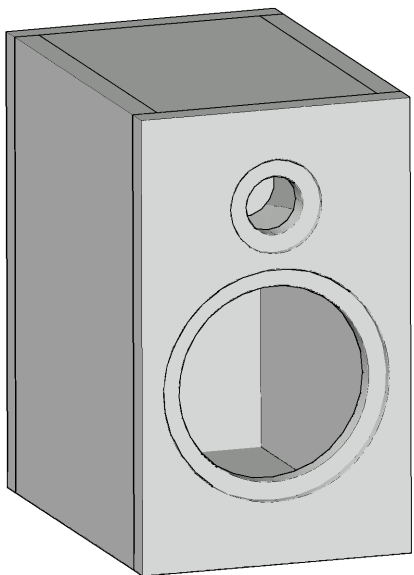

CSS CRITON 1TD UTILIZES ULTRA LOW DISTORTION DRIVERS
CSS LDW7 MID WOOFER AND LD22 SOFT DOME TWEETER INTEGRATE SEAMLESSLY
FREQUENCY RESPONSE 41Hz - 24KHz +/-3dB

CRITON 1TD
07-JANUARY-2021
DESIGNED BY D POINSETT/K ARMES | DRAWN BY MM
© 2017-18 CREATIVE SOUND SOLUTIONS, LCC

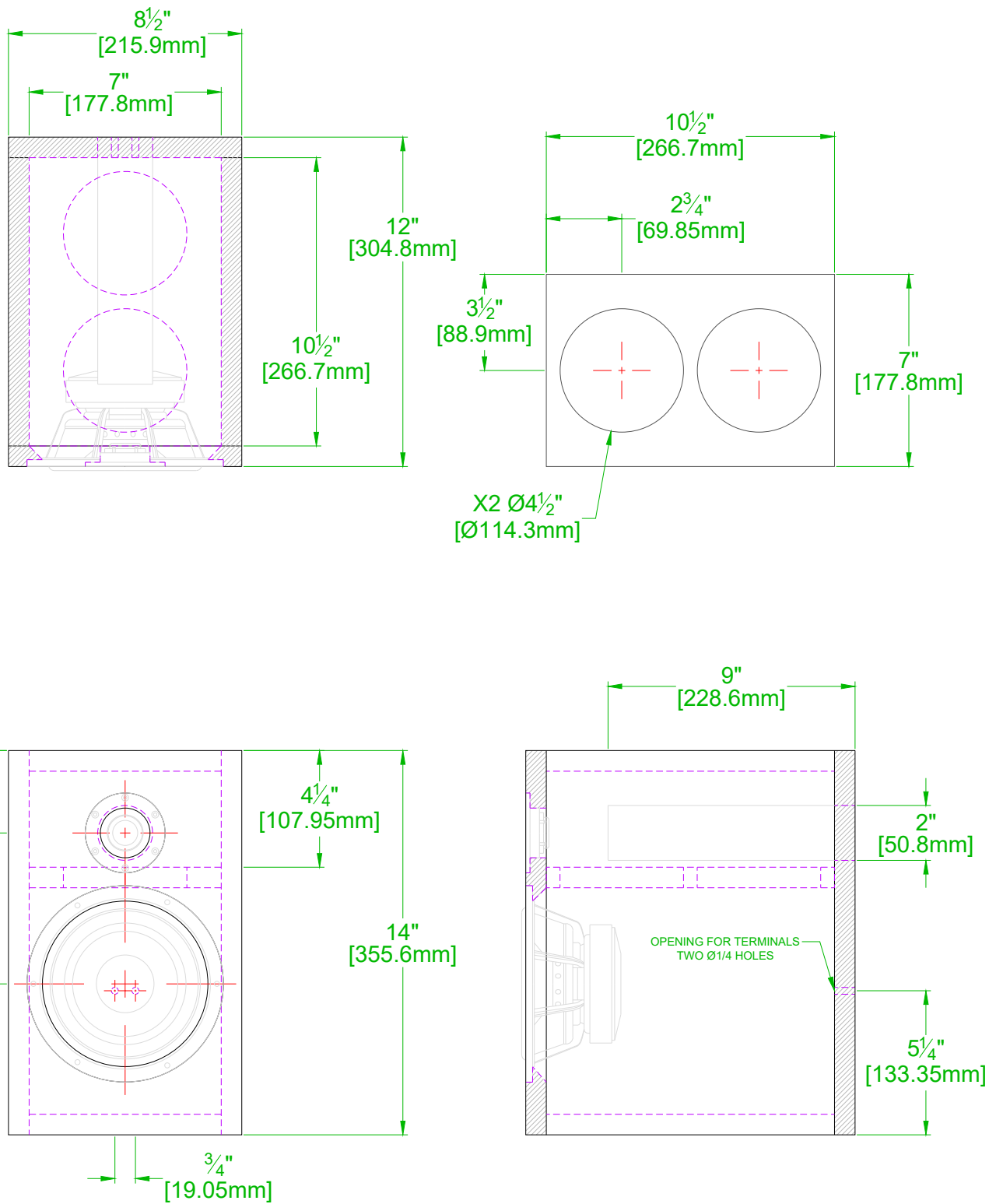

NOTES:

- 1) USES CSS LD22 TWEETER AND CSS LDW7 MIDWOOFER
- 2) DRAWN WITH $\frac{1}{8}"$ [19.05mm] MATERIAL. QUALITY PLYWOOD OR MDF RECOMMENDED
- 3) LINE WALLS WITH FIBERGLASS, WOOL, OR COTTON FELT
- 4) CHAMFER OR ROUND-OVER THE BACK OF LDW7 BAFFLE CUT OUT
- 5) PORT DIMENSIONS SHOWN ARE ID AND LENGTH OF THE ACTUAL PORT. HOLE SIZE FOR PORT THAT COMES IN CSS KIT SHOULD BE 2.375"



CRITON 1TD DIMENSIONS
07-JANUARY-2021
DESIGNED BY D POINSETT/K ARMES | DRAWN BY MM
© 2017-18 CREATIVE SOUND SOLUTIONS, LCC

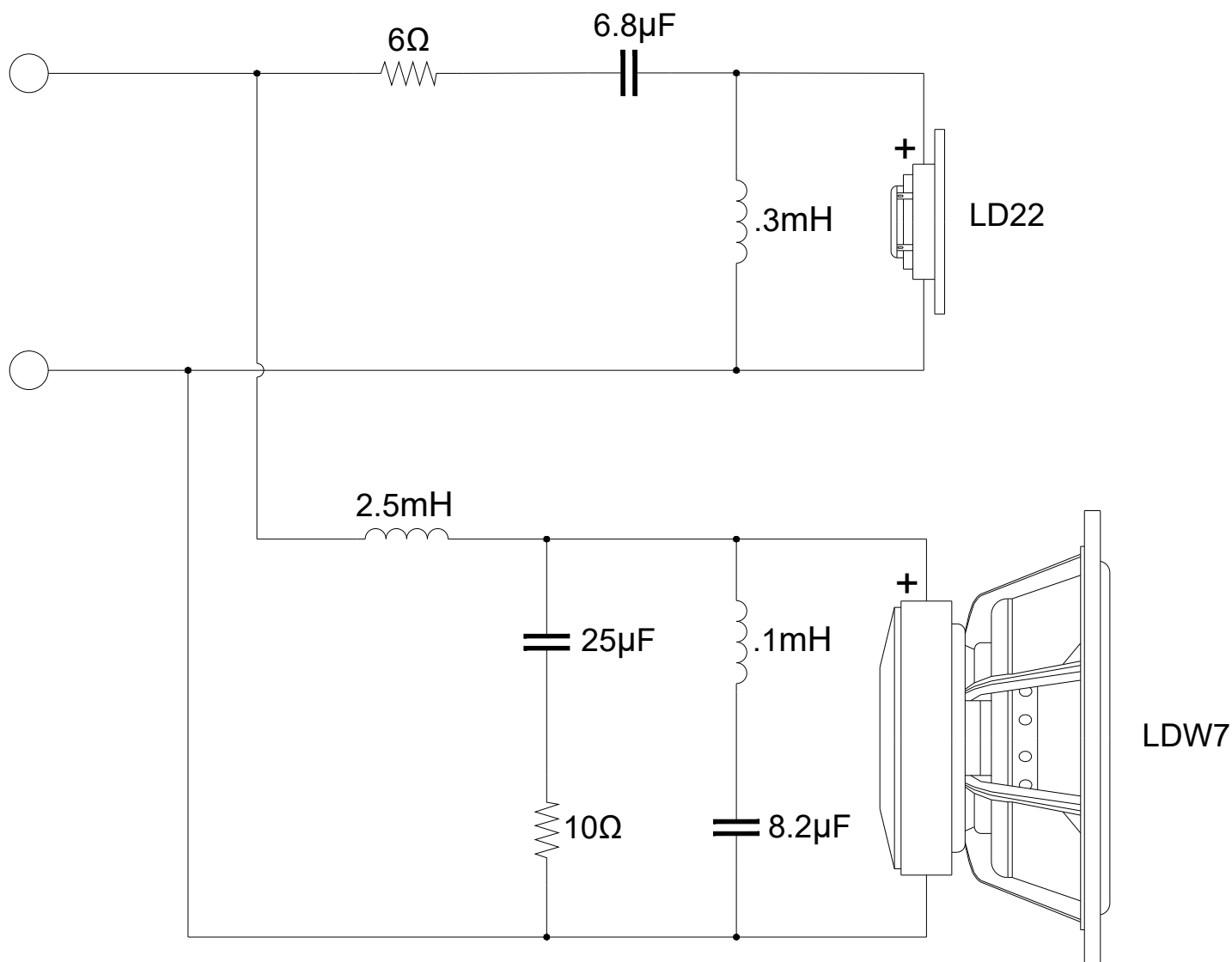

CRITON 1TD CROSSOVER
 07-JANUARY-2021
 DESIGNED BY D POINSETT/K ARMES | DRAWN BY MM
 © 2017-18 CREATIVE SOUND SOLUTIONS, LCC

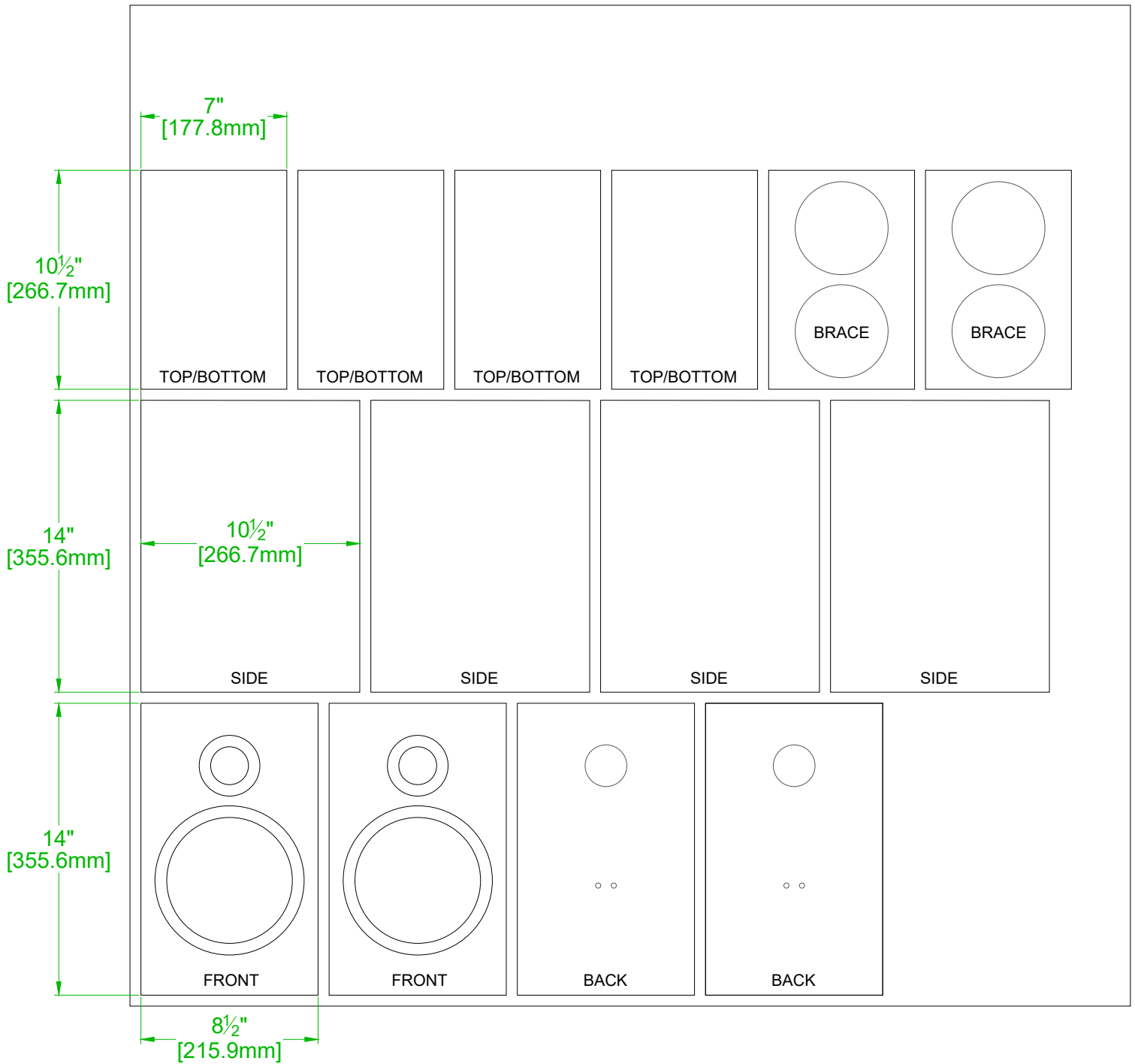

NOTES:

- 1) 4' X 4' SUGGESTED CUT OUT. 3/4" [19.05MM] QUALITY PLYWOOD OR MDF RECOMMENDED
- 2) 1/4" [6.4mm] TRIM AND KERF
- 3) BEFORE CUTTING MEASURE THE ACTUAL MATERIAL'S THICKNESS AND ADJUST PANEL SIZES AS REQUIRED



CRITON 1TD SUGGESTED CUT 4' X 4'
 07-JANUARY-2021
 DESIGNED BY D POINSETT/K ARMES | DRAWN BY MM
 © 2017-18 CREATIVE SOUND SOLUTIONS, LCC

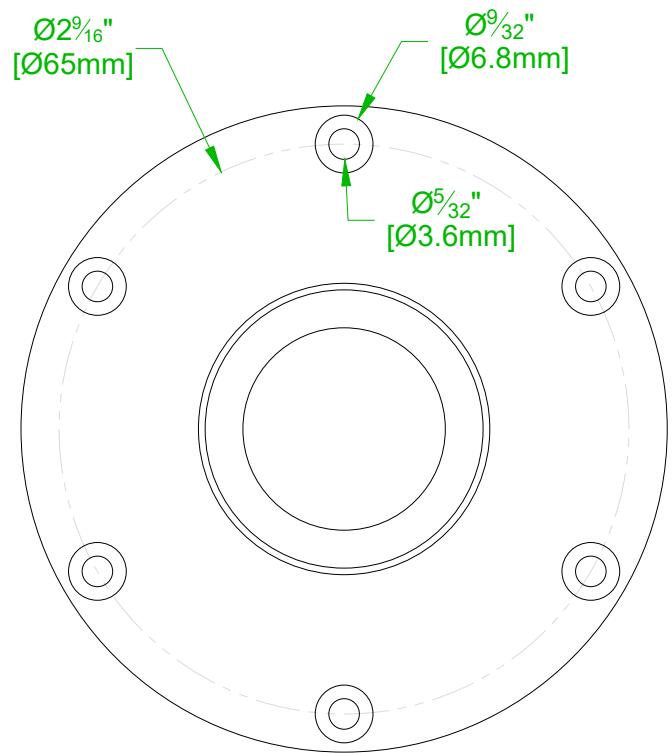
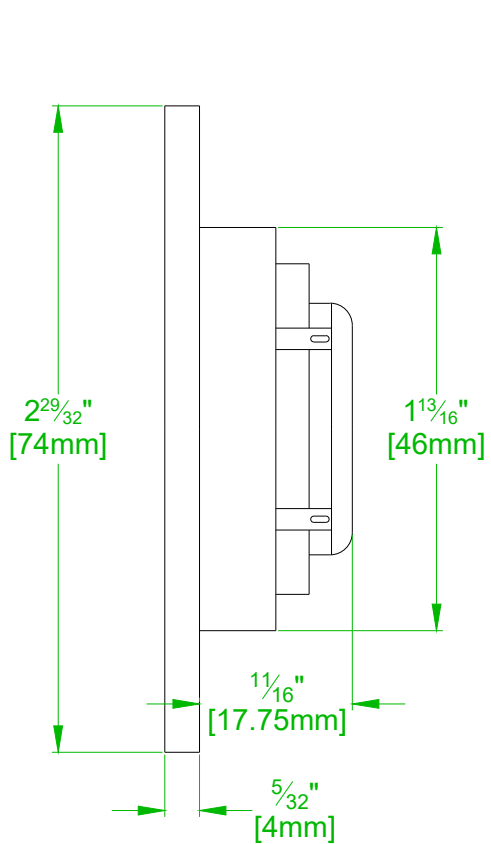

CSS LD22 TWEETER DIMENSIONS
 07-JANUARY-2021
 DESIGNED BY D POINSETT/K ARMES | DRAWN BY MM
 © 2017-18 CREATIVE SOUND SOLUTIONS, LCC

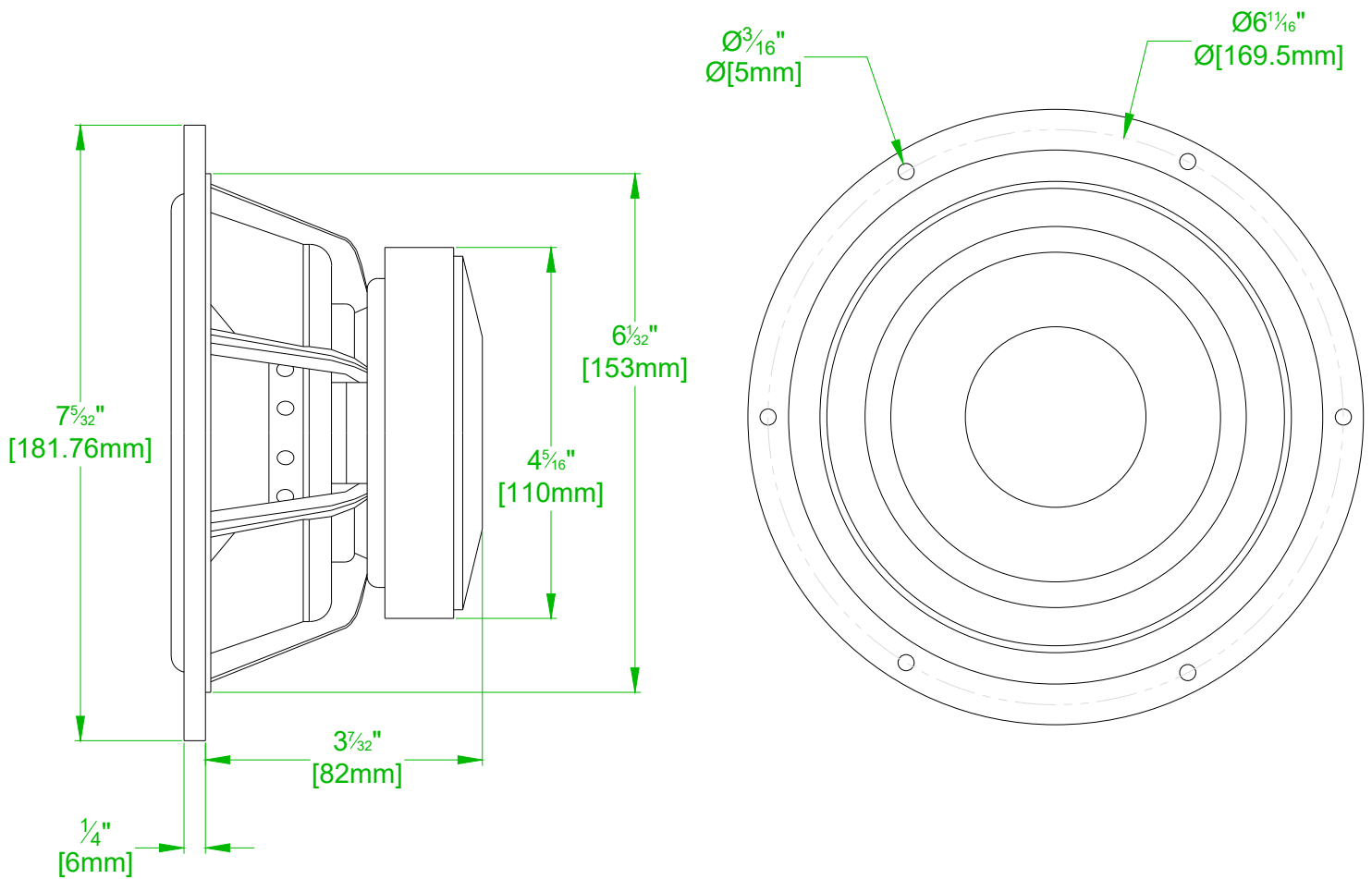

CSS LDW7 MIDWOOFER DIMENSIONS
 07-JANUARY-2021
 DESIGNED BY D POINSETT/K ARMES | DRAWN BY MM
 © 2017-18 CREATIVE SOUND SOLUTIONS, LCC