



CREATIVE SOUND SOLUTIONS

TORII TOWER P2
CSS T22-04 + W5-06

8 - NOVEMBER - 2023



CSS TORII TOWER P2 UTILIZES HIGH QUALITY, LOW DISTORTION DRIVERS IN A 3-WAY DESIGN.
CSS T22-04 SOFT DOME TWEETER INTEGRATES SEAMLESSLY WITH W5-06 MIDRANGE AND 2X
W5-06 UTILIZED AS WOOFERS IN A PORTED ENCLOSURE.
FREQUENCY RESPONSE 32Hz - 20KHz +/-3dB (ANECHOIC)

TORII TOWER P2
8-NOVEMBER-2023
DESIGNED BY D POINSETT/K ARMES | DRAWN BY MM
© 2017-18 CREATIVE SOUND SOLUTIONS, LCC

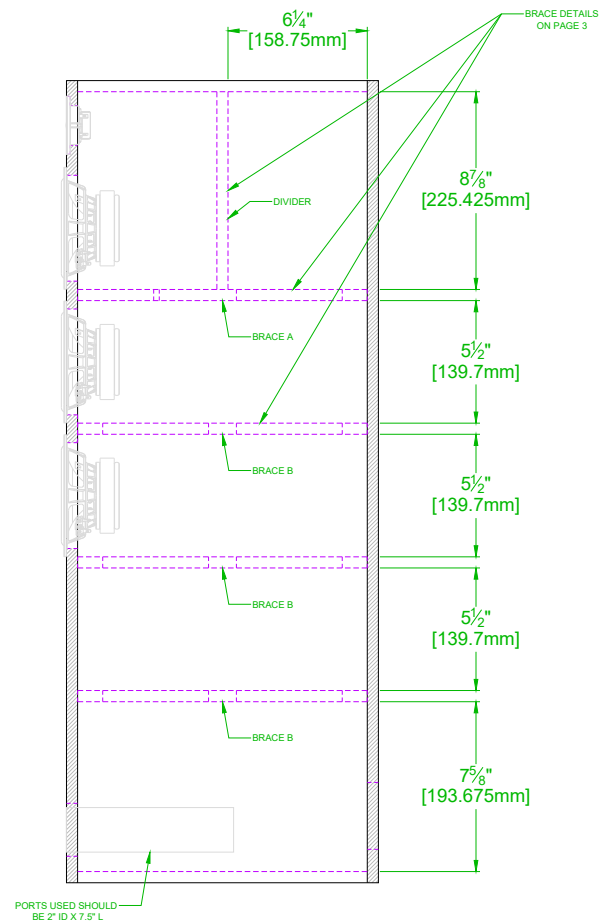
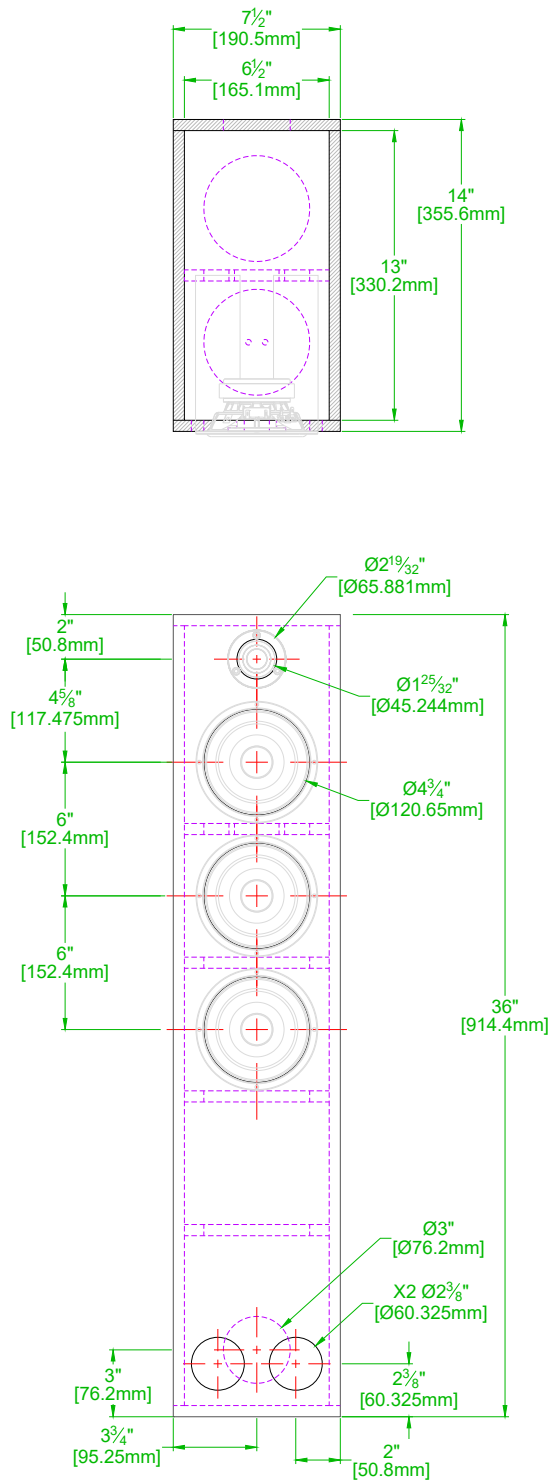

NOTES:

- 1) USES CSS T22-04 TWEETER AND CSS W5-06 MIDWOOFER
- 2) DRAWN WITH $\frac{1}{8}"$ [12.7MM] MATERIAL. QUALITY PLYWOOD OR MDF RECOMMENDED
- 3) LINE WALLS WITH FIBERGLASS, WOOL, OR COTTON FELT
- 4) THIS DESIGN USES TWO 2" ID X 7.5" L PORTS. THE CUTOUTS SHOWN OF 2.375" WORK WITH PORTS SUPPLIED IN CSS KITS. IF USING PVC OR OTHER TUBING, THIS HOLE SIZE MAY NEED TO BE MODIFIED.



TORII TOWER P2 DIMENSIONS

8-NOVEMBER-2023

DESIGNED BY D POINSETT/K ARMES | DRAWN BY MM
© 2017-18 CREATIVE SOUND SOLUTIONS, LCC

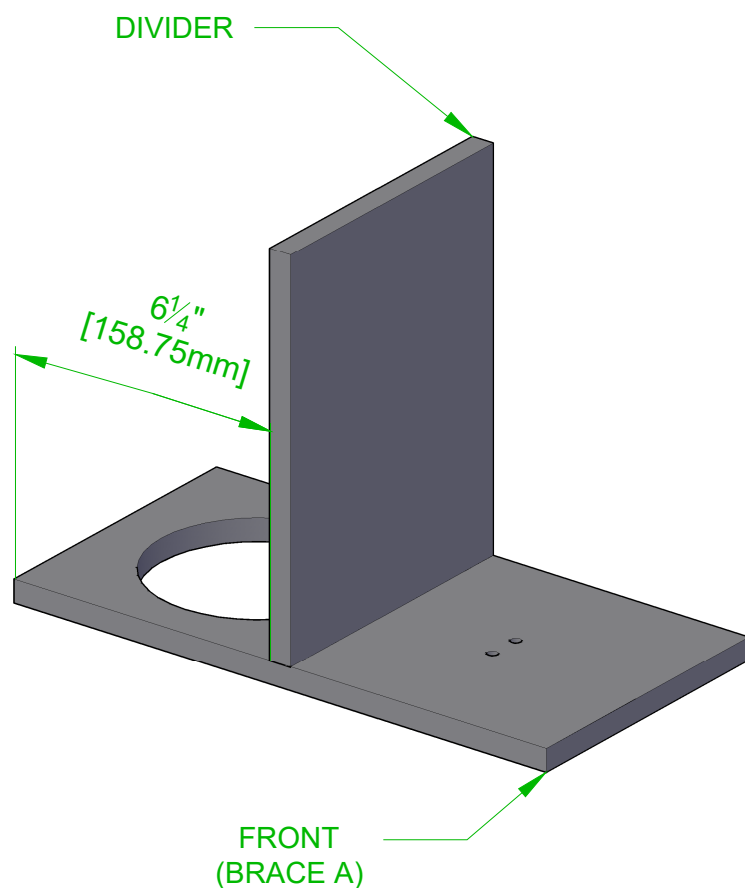
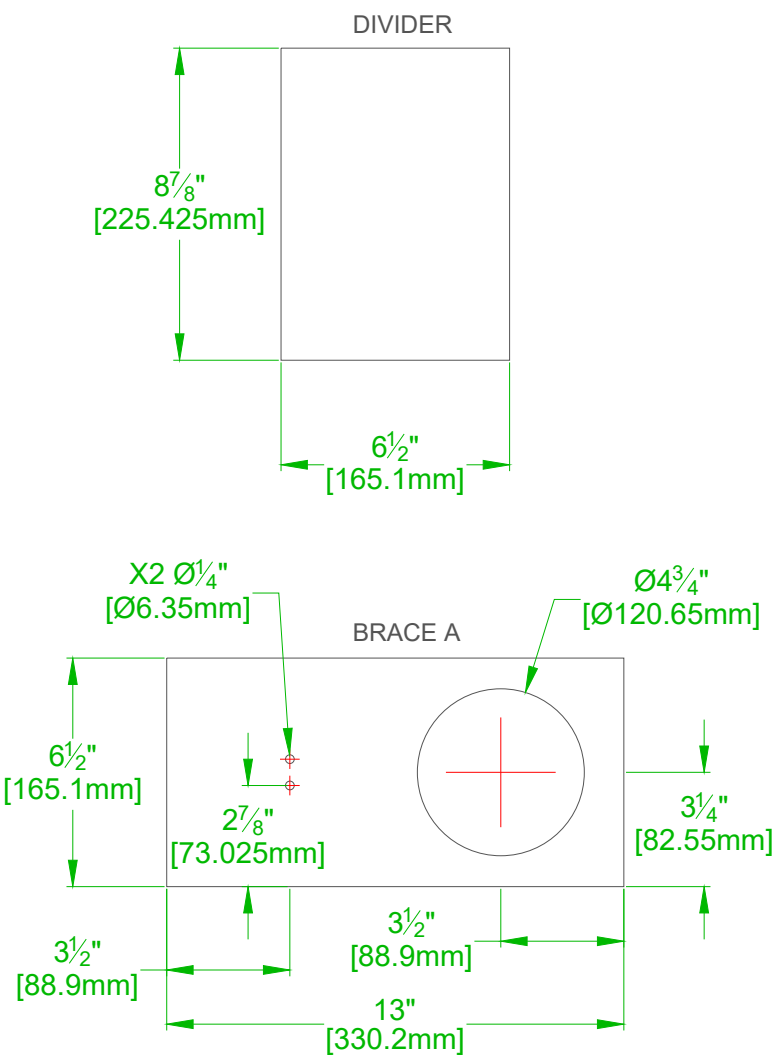

RELATIVE ORIENTATION OF THE DIVIDER AND BRACE A

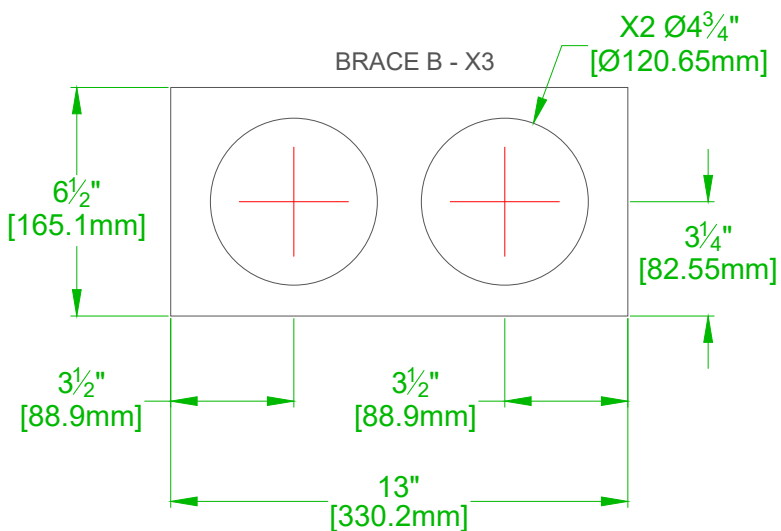

NOTES:

- 1) DRAWN WITH ½" [12.7MM] MATERIAL. QUALITY PLYWOOD OR MDF RECOMMENDED



TORII TOWER P2 BRACE DIMENSIONS
8-NOVEMBER-2023
DESIGNED BY D POINSETT/K ARMES | DRAWN BY MM
© 2017-18 CREATIVE SOUND SOLUTIONS, LCC

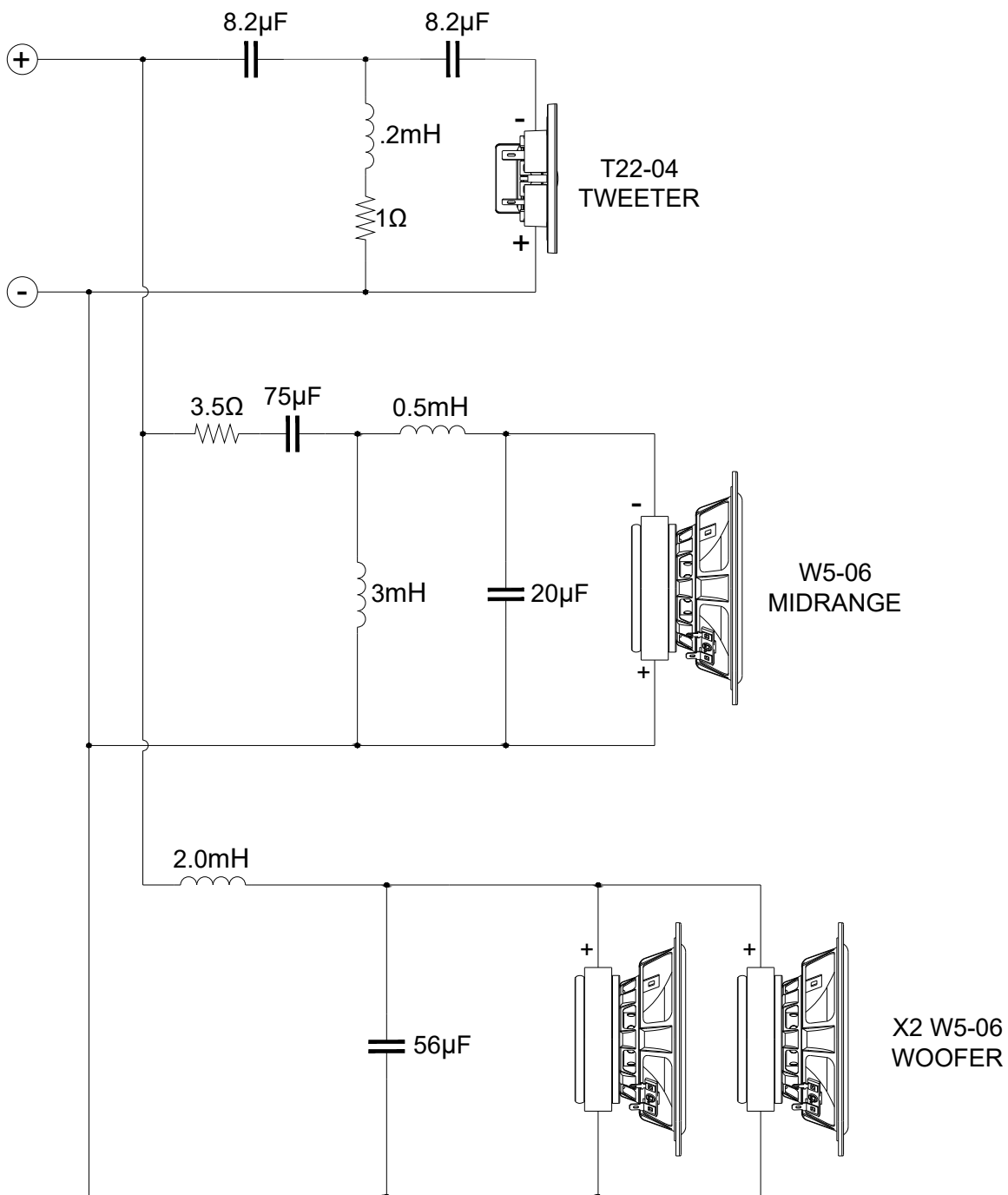

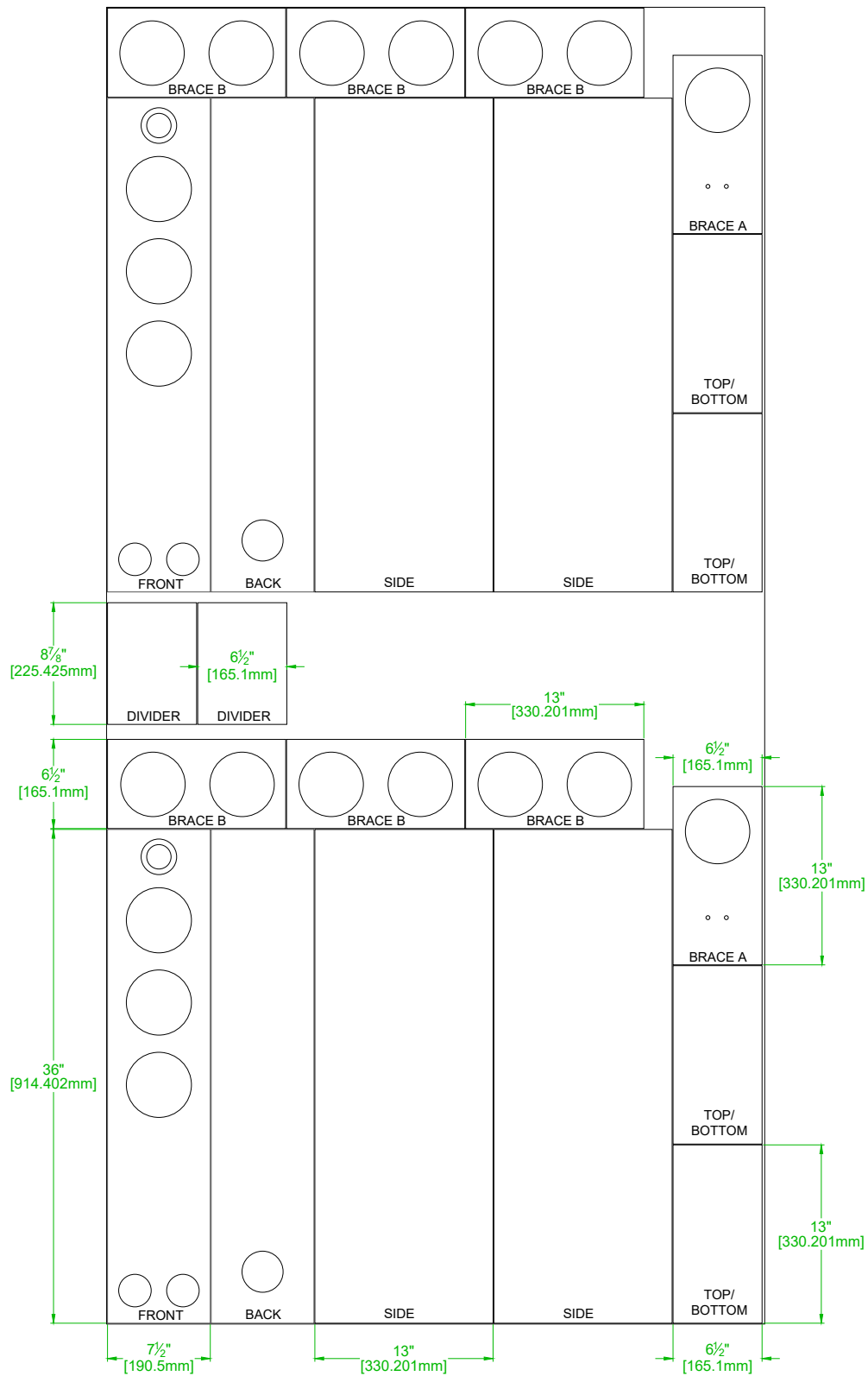

NOTES:

- 1) 8' X 4' SUGGESTED CUT OUT. 1/2" [12.7MM] QUALITY PLYWOOD OR MDF RECOMMENDED
- 2) 1/4" [6.4mm] TRIM AND KERF
- 3) BEFORE CUTTING MEASURE THE ACTUAL MATERIAL'S THICKNESS AND ADJUST PANEL SIZES AS REQUIRED



TORII TOWER P2 SUGGESTED CUT 8' X 4'
 8-NOVEMBER-2023
 DESIGNED BY D POINSETT/K ARMES | DRAWN BY MM
 © 2017-18 CREATIVE SOUND SOLUTIONS, LCC

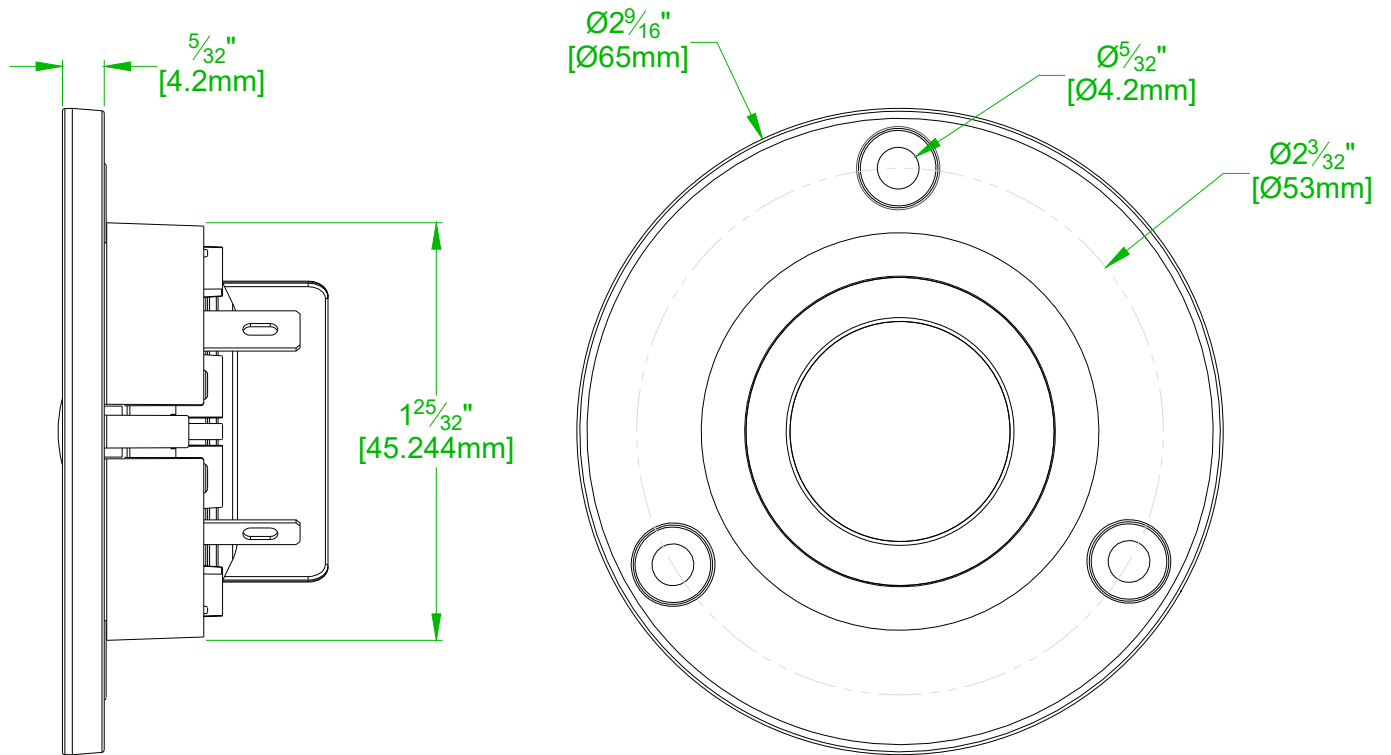

CSS T22-04 TWEETER DIMENSIONS
 8-NOVEMBER-2023
 DESIGNED BY D POINSETT/K ARMES | DRAWN BY MM
 © 2017-18 CREATIVE SOUND SOLUTIONS, LCC

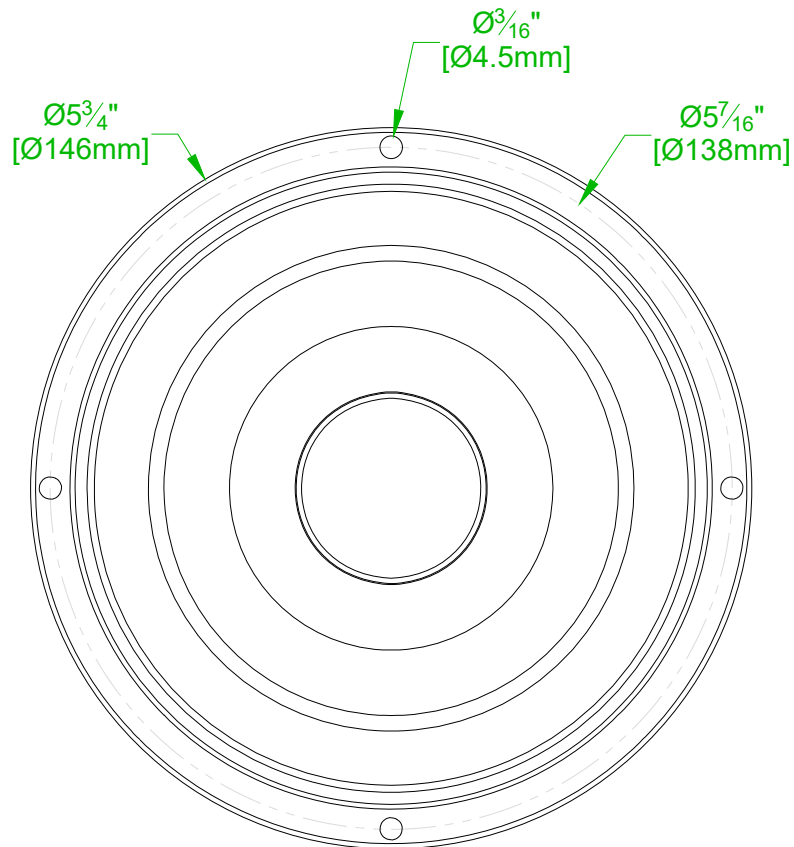
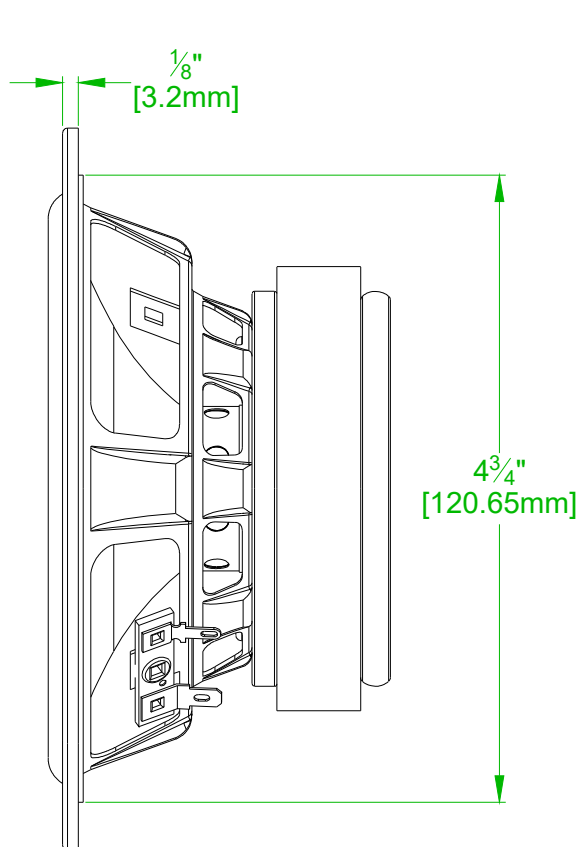

CSS W5-06 MIDWOOFER DIMENSIONS
 8-NOVEMBER-2023
 DESIGNED BY D POINSETT/K ARMES | DRAWN BY MM
 © 2017-18 CREATIVE SOUND SOLUTIONS, LCC